

## Close Limit Setting

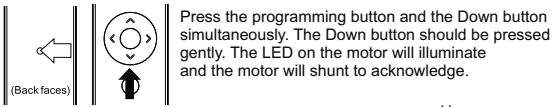

Select the desired position, pressing the Up and Down buttons gently. Function 1 & 2 buttons will "inch" the motor

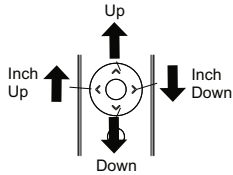
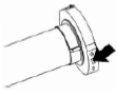

Press the programming button on the rear of the transmitter or the setting button on the motor to store limit

## Limit Switch Deleting

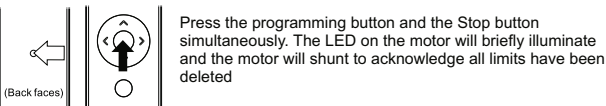

## Touch Control On / Off - Curtains Only

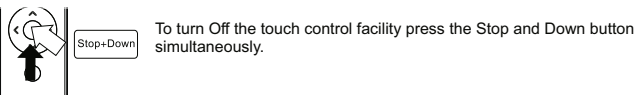
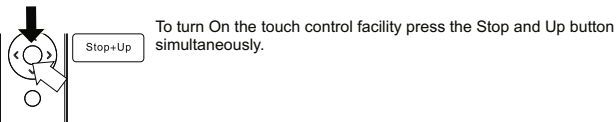

## Warranty

This product carries a one year warranty from date of invoice. Damage caused by misuse or disassembly will be excluded from any warranty.

# Raex®

# YR2116

## Transmitter Specification



## Product specification

Model	YR2116
Transmission range	30meters
Transmission frequency	433.92MHz ± 75KHz
Modulation mode	ASK
Battery	CR2032×1PC
Remote channel	7channels

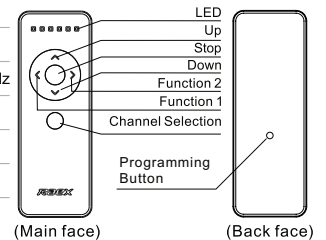

## Functions Of Buttons

[Up] [Stop] [Down] respectively transmits the command to open, stop & close for the selected channel.

[Channel Selection] is used to scroll through and select channels

[Programming Button] is used to programme transmitter to motor and for setting limits. Please refer to <Remote Control Setting>

[Function 1] & [Function 2] are used as intermediate stop functions for opening and closing curtains, venetian blind tilting and for other systems with the partial open / close functionality. Please refer to product instructions for available functionality.

## Channel Selection

Channel Indication LED's



Channel Selection Button

The YR2116 Transmitter is a 7 channel transmitter.

The channels are selected by the Channel Selection button.

Each press of the button advances to the next channel and the relevant LED illuminates to indicate the number.

Channel 7 is indicated by all 6 LED's on the transmitter being illuminated and is often used as a group channel by linking multiple motors to it.

For example

Motors 1 to 6 are assigned to channels 1 to 6 respectively and then all 6 are additionally assigned to channel 7. In this scenario the motors can be individually controlled via their respective channels or as a group on channel 7

## Remote control setting

### Basic remote control setting

Before using the remote control, the user must first link the transmitter to the device to be controlled.

If you make a mistake you can delete a remote channel by following the instructions outlined.

If required the running direction of the motor can be altered <Reverse Motor Direction>

### Linking the transmitter to the device

① Put the device in setting mode

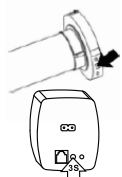

Press the setting button on the motor. The LED will illuminate

② Choose Channel

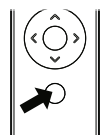

Select the desired channel with the Channel button

③ Confirm Channel

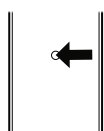

Press programming button on the back of the transmitter until the LED on the motor flashes

④ Storing Channel



Press the setting button on the motor head again. The LED will go out. The channel is now set

### Deleting transmitters from the device

① Put the device in setting mode

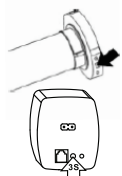

Press the setting button on the motor. The LED will illuminate

② Delete transmitters



Press the setting button again for 7 seconds until the LED goes out. All transmitters / channels have now been deleted from the motor

## Combination functions

Combination buttons will transmit function signals as below:

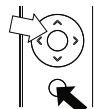

Hollow arrow symbol means long press



Solid arrow symbol means short / gentle press

Note:

1. Combination buttons are effective on receivers with corresponding functions.
2. Ensure the transmitter is on the required channel
3. The settings may differ between each controlled device. Please refer to individual motor instructions for functionality.

## Reverse Motor Direction



Press the setting button on the motor. The LED will illuminate



Press Channel Selection & Stop button Simultaneously to transmit the reversing signal

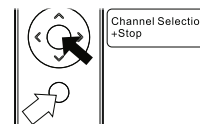

The LED will now flash to acknowledge the request. Press the setting button on the motor again and the LED will go out

## Open Limit Setting

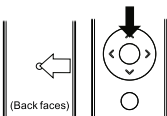

Press the programming button and the Up button simultaneously. The Up button should be pressed gently. The LED on the motor will illuminate and the motor will shunt to acknowledge.

Select the desired position, pressing the Up and Down buttons gently. Function 1 & 2 buttons will "inch" the motor

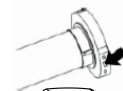
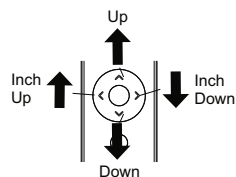

Press the programming button on the rear of the transmitter or the setting button on the motor to store limit